

**Hope Star**  
 (aka Sawtooth Star)  
**Block Instructions**  
 8" X 8" (finished size)

Fabric Choices

Use a light-colored, neutral background print, and **one** print to make the Hope Star.  
**Note:** Do not use white for the background; do not use any solids.

**Cutting for One Block**

For the background, from a neutral print cut:

- 4 – 2½" X 4½" rectangles
- 4 – 2½" X 2½" squares

For the star, from one print cut:

- 1 - 4½" X 4½" square
- 8 - 2½" X 2½" squares

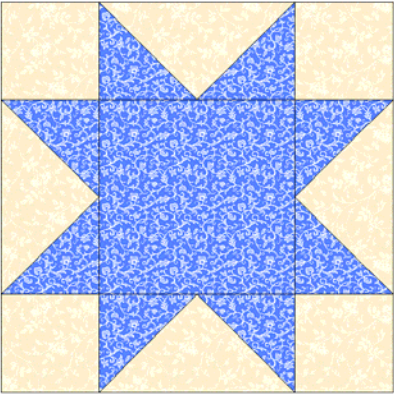

**Make a Flying Geese Rectangle**

Sew a 2½" X 2½" star print square to opposite corners of a 2½" X 4½" background rectangle. Trim away extra fabric ¼" from the seam line. Press triangle toward corner.

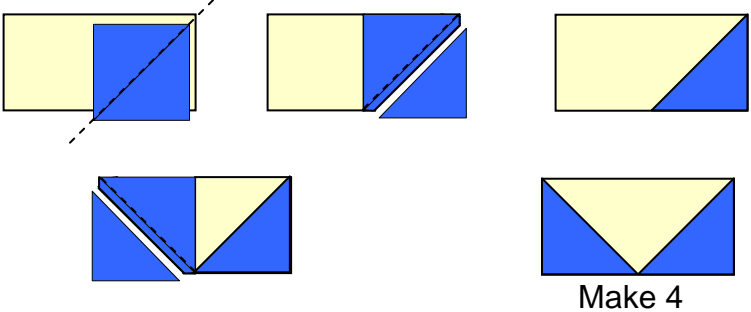

**Assemble** as shown.  
 Press seams as indicated by arrows.

The unfinished star should measure 8½" X 8½".

